

高压齿轮泵



高压齿轮泵HPG2系列



型号/Model number

HPG2 - 2.5 F 1 02 R
1 2 3 4 5 6 7

- | | | |
|---|---|---|
| <p>1. 系列型号/ Series number
HPG2 系列/HPG2 series</p> <p>2. 安装形式/Mounting spigot dia.
- : 82.6 - Φ50.8
A: 106.4 - Φ82.55
K: 72x52.4 - Φ25.4</p> <p>3. 规格/Size
1,1.5,2.1,2.5,3.6,4.2,5.0,6.1,8.5,9.8</p> | <p>4. 油口位置/ Position of ports
F : 侧端/side ports
D : 后端/rear ports</p> <p>5. 油口形式/ Port configuration
1 : F法兰/Flange typeF (见尺寸图see the drawing)
2 : G 螺纹/G screw thread
3 : M 螺纹/M screw thread</p> | <p>6. 驱动轴类型/Shaft end
01 : 锥轴半圆键/Semicircle key
02 : 圆轴平键/Straight keyed shaft
09 : SAE 9齿花键/SAE Spline 9 teeth</p> <p>7. 旋向/Rotation viewing from shaft end
L : 逆时针/counterclockwise
R : 顺时针/clockwise</p> |
|---|---|---|

技术参数/Specifications

规格/Size	排量	流量*	额定压力/Rated press		峰值压力/Max. press		转速/r/min		进口压力	外形尺寸/Dimension			
	cm ³	L/min	MPa	bar	MPa	bar	MIN.	MAX.	Inlet pressure	进油口Inlet	出油口Outlet	A(mm)	B(mm)
HPG2-1.0	1.0	1.4	20	200	25	250	500	3500	bar -0.20~2.0	M16X1.5 G3/8"	M16X1.5 G3/8"	41.1	83
HPG2-1.5	1.5	2.1										42.3	85.6
HPG2-2.1	2.1	2.9					43.1	87.2					
HPG2-2.5	2.5	3.5					44	89.2					
HPG2-3.6	3.6	5.1					46.4	93.9					
HPG2-4.2	4.2	5.9					47.5	96.1					
HPG2-5.0	5.0	7.1					49.1	99.2					
HPG2-6.1	6.1	8.7					51.4	103.8					
HPG2-8.5	8.5	12.1					56.4	113.7					
HPG2-9.8	9.8	14					59	119					

*上表流量的标定状态为1500rpm转速下。

外形尺寸图/Dimensions

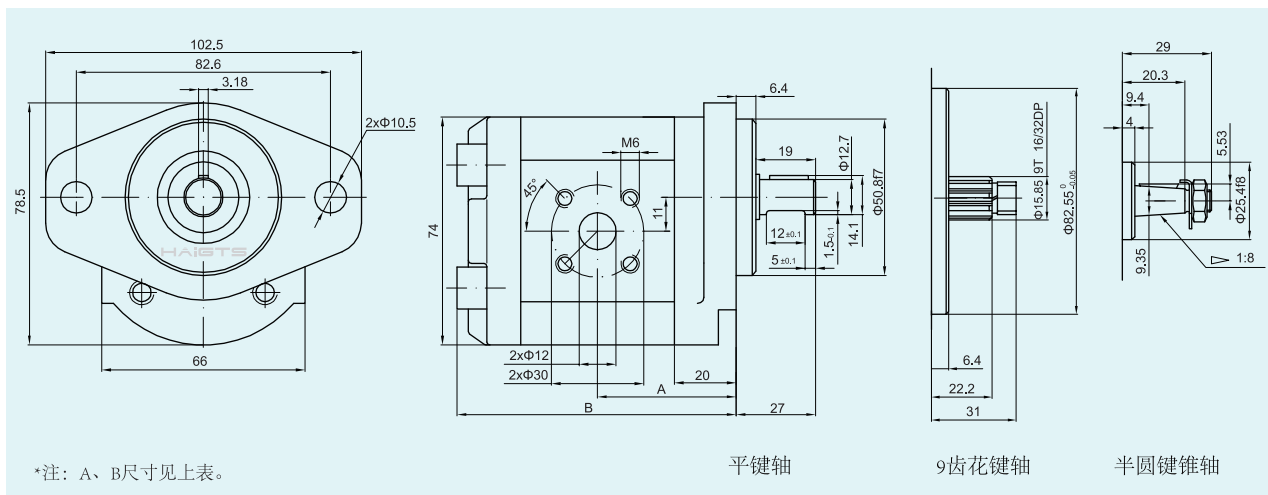

高压齿轮泵HPG3系列



型号/Model number

HPG3
A
25
F
1
02
R

1
2
3
4
5
6
7

- | | | |
|--|--|--|
| <p>1. 系列型号/Series number
HPG3系列/HPG3 series</p> <p>2. 安装形式/Mounting spigot diameter
—: 82.6 - Φ50.8
A: 106.4 - Φ82.55</p> <p>3. 规格/Size
6,8,10,12,14,15,16,19,22,25,32,36,40</p> | <p>4. 油口位置/Position of ports
F: 侧端/side ports
D: 后端/rear ports</p> <p>5. 油口形式/Port configuration
1: F法兰/Flange typeF (见尺寸图see the drawing)
2: SAE法兰/Flange typeSAE
3: G螺纹/G screw thread
4: M螺纹/M screw thread</p> | <p>6. 驱动轴类型/Shaft end
02: 圆轴平键/Straight keyed shaft
09: SAE 9齿花键/SAE Spline 9 teeth
11: SAE11齿花键/SAE Spline 11 teeth</p> <p>7. 旋向/Rotation viewing from shaft end
L: 逆时针/counterclockwise
R: 顺时针/clockwise</p> |
|--|--|--|

技术参数/Specifications

规格/Size	排量	流量*	额定压力/Rated press		峰值压力/Max. press		转速/ r/min		进口压力 Inlet pressure	外形尺寸/Dimension			
	cm ³	L/min	MPa	bar	MPa	bar	MIN.	MAX.		进油口Inlet	出油口Outlet	A(mm)	B(mm)
HPG3-06	6.3	8.7	20	200	25	250	500	3500	bar -0.20~2.0	M20X1.5 G1/2"	M16X1.5 G1/2"	37.3	75
HPG3-08	8.2	11.3								40.6		78	
HPG3-10	10	14								45		87	
HPG3-12	12	16.9								45		90.3	
HPG3-14	14	20								45		93.4	
HPG3-15	15	21.6								45		94.9	
HPG3-16	16	23					M20X1.5 G3/4"	45	96.5				
HPG3-19	19	27.3						45	101.5				
HPG3-22	22	31.7						M20X1.5 G1/2"	52.5	106.5			
HPG3-25	25	36					SAE	57	111.5				
HPG3-32	32	46.1						SAE 3000	SAE 3000	67	121.5		
HPG3-36	36	52						1"	3/4"	69	123.5		
HPG3-40	40	57.3						26.2x52.4	22.3x47.6	71.5	125.5		

*上表流量的标定状态为1500rpm转速下。

外形尺寸图/Dimensions

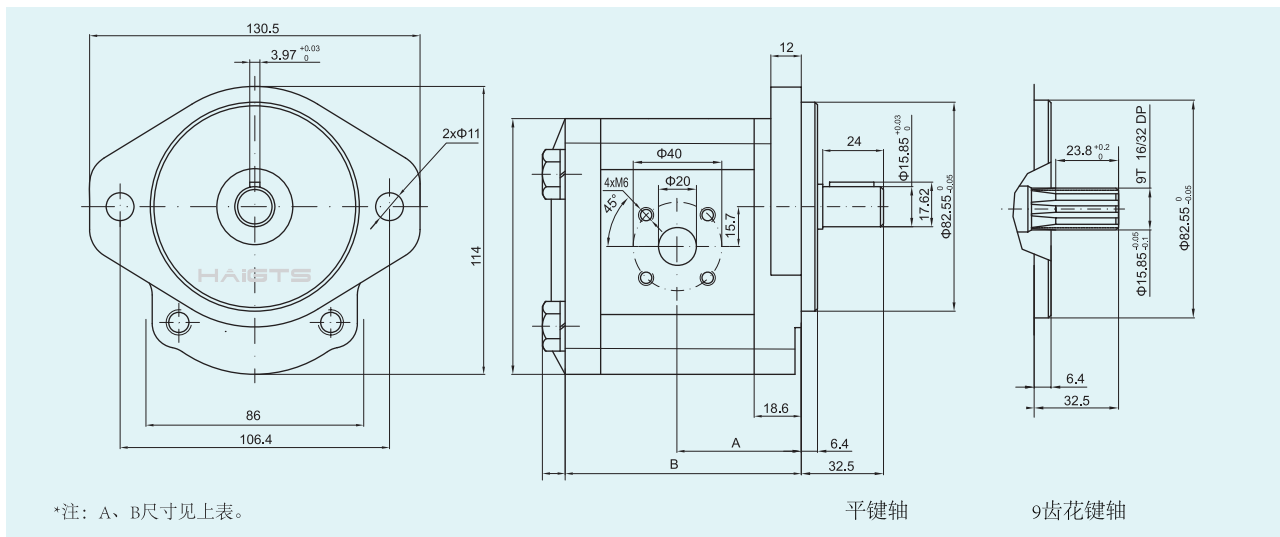

高压齿轮泵HPM3系列

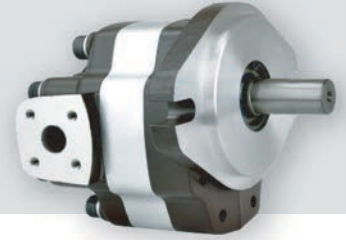

型号/Model number

HPM3 - 25 F 1 1 R

1
2
3
4
5
6
7

- | | | | |
|--|--|---|---|
| <p>1. 系列型号/Series number
HPM3系列/HPM3 series</p> <p>2. 安装形式/Mounting spigot diameter
- : 106.4 - Φ82.55
A : 106.4 - Φ80</p> <p>3. 规格/Size
5, 6, 8, 10, 12, 14, 16, 20, 25, 30</p> | <p>4. 油口位置/Position of ports
F: 侧端/side ports</p> <p>5. 油口形式/Port configuration
1: F法兰/Flange typeF (见尺寸图see the dimensions)
2: G螺纹/G screw thread
3: M螺纹/M screw thread</p> | <p>6. 驱动轴类型/Shaft end
1: SAE 9齿花键/SAE Spline 9 teeth
2: 圆轴平键/Flat key</p> | <p>7. 旋向/Rotation viewing from shaft end
L = 逆时针/counterclockwise
R = 顺时针/clockwise</p> |
|--|--|---|---|

技术参数/Specifications

规格/Size	排量	流量*	额定压力/Rated press		峰值压力/Max. press		转速/r/min		外形尺寸/Dimension				重量/Weight
	cm ³	L/min	MPa	bar	MPa	bar	MIN.	MAX.	进油口Inlet	出油口Outlet	A(mm)	B(mm)	
HPM3-5	5.1	7.5	20	200	25	250	1000	4000	M16X1.5 G1/2"	M16X1.5 G1/2"	84	59	1.8
HPM3-6	6.0	8.9									86	61	1.9
HPM3-8	8.1	12.1									88	63.5	2.0
HPM3-10	10	14.9									91	66.5	2.1
HPM3-12	12	17.8	20	200	25	250	850	3600	M20X1.5 G3/4"	M20X1.5 G3/4"	95.5	70.5	2.2
HPM3-14	14	19.8									97	73	2.3
HPM3-16	16	22.8									100.5	75.5	2.4
HPM3-20	20	28.6									106.5	81.5	2.5
HPM3-25	25	35.6	20	200	25	250	800	2800	M20X1.5 G3/4"	M20X1.5 G3/4"	114.5	89.5	2.7
HPM3-30	30	42.7									122.5	97.5	2.9

*上表流量的标定状态为1500rpm转速下。

外形尺寸图/Dimensions

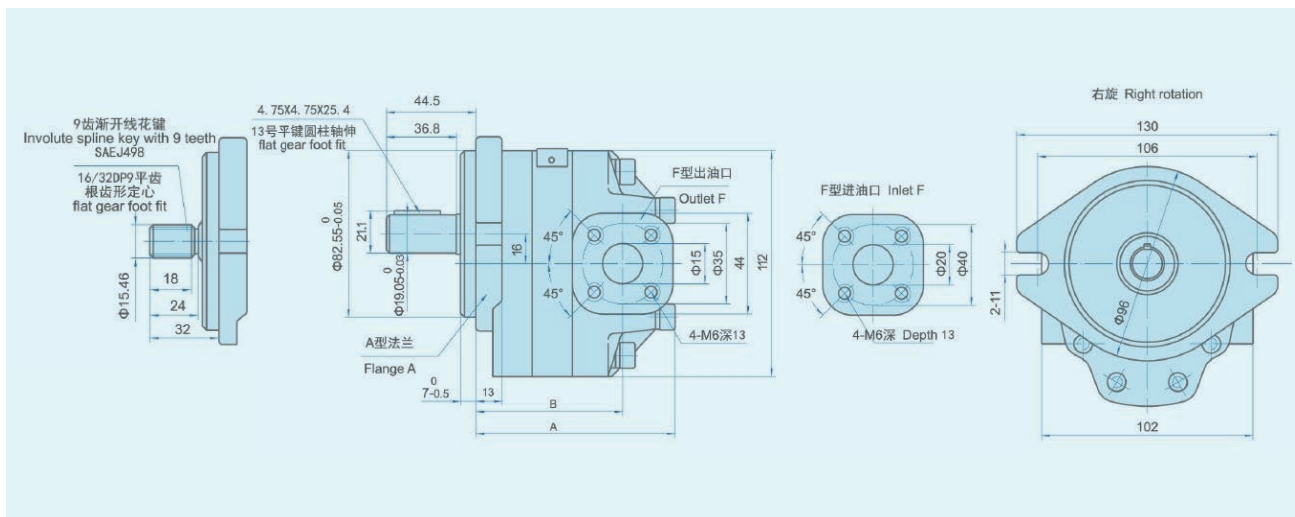

高压齿轮泵HPG4系列



HPG4系列是基于美国VICKERS技术研发的高压力宽流量齿轮泵产品，设计用于高压力，高工作强度的环境。广泛用于移动机械，工程机械，起重机，升降车，液压系统等设备作为液压动力源。HPG4系列可提供多种接口方式。

型号/Model number

HPG4 A 63 F 1 02 R
 1 2 3 4 5 6 7

- | | | |
|---|--|---|
| <p>1. 系列型号/Series number
HPG4单泵/Single HPG4 series</p> <p>2. 安装形式/Mounting spigot dia.
A: 106.4 - Φ82.55
B: 146 - Φ101.6</p> <p>3. 规格/Size
20、26、32、40、50、63、80</p> | <p>4. 油口位置/Position of ports
F: 侧端/side ports
D: 后端/rear ports</p> <p>5. 油口形式/Port configuration
1: F法兰/Flange typeF (见尺寸图see the drawing)</p> | <p>6. 驱动轴类型/Shaft end
02: 圆轴平键/Straight keyed shaft
13: SAE 13齿花键/SAE Spline 13 teeth
15: SAE 15齿花键/SAE Spline 15 teeth</p> <p>7. 旋向/Rotation viewing from shaft end
L: 逆时针/ counterclockwise
R: 顺时针/ clockwise</p> |
|---|--|---|

技术参数/Specifications

规格/Size	排量	流量*	额定压力/Rated press		峰值压力/Max. press		转速/ r/min		进口压力 Inlet pressure	外形尺寸/Dimension			
	cm ³	L/min	MPa	bar	MPa	bar	MIN.	MAX.		进油口Inlet	出油口Outlet	A(mm)	B(mm)
HPG4-20	20.8	29	25	250	30	300	900	3500	bar -0.20~2.0	Port:Φ32 4-M10 58.7x30.2	Port:Φ25 4-M10 52.4x26.2	157	119
HPG4-26	26.2	36										161	123
HPG4-32	32.8	45										166	128
HPG4-40	41.9	58	20	200	25	250	800	2500	MPa -0.02~0.2			173	135
HPG4-50	52.5	72										181	143
HPG4-63	65.5	89										191	153
HPG4-80	78.8	106	18	180	23	230						201	163

*上表流量的标定状态为1500rpm转速下。

外形尺寸图/Dimensions

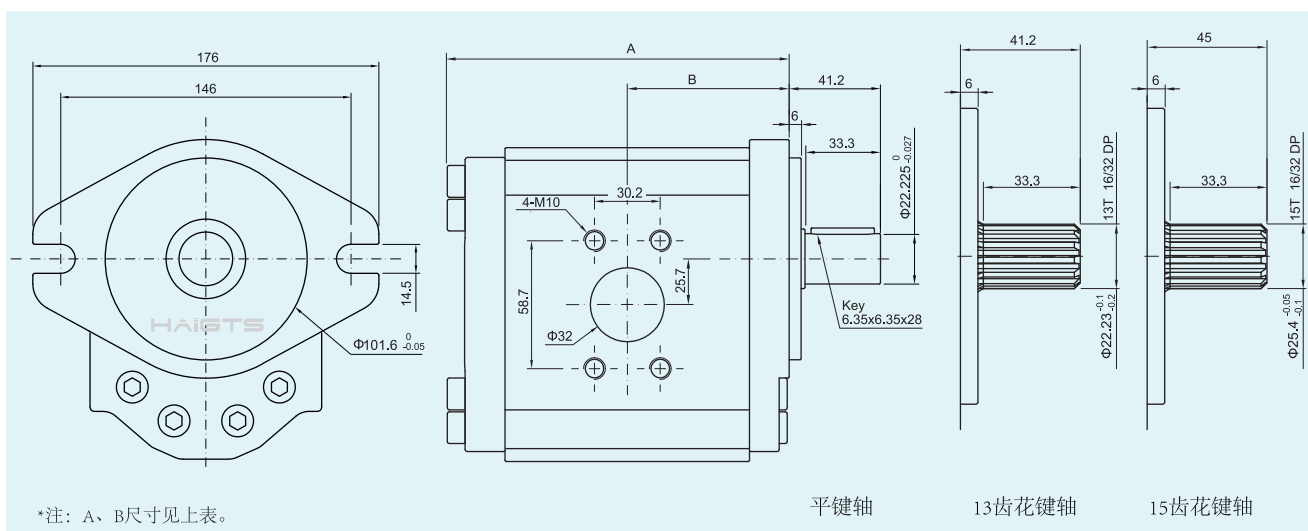

*注: A、B尺寸见上表。



HPG4系列多联形式

HPG4系列高压齿轮泵可提供双联、三联、四联等结构形式，广泛应用于移动机械、液压系统、压力机等机械液压设备。

型号/Model number

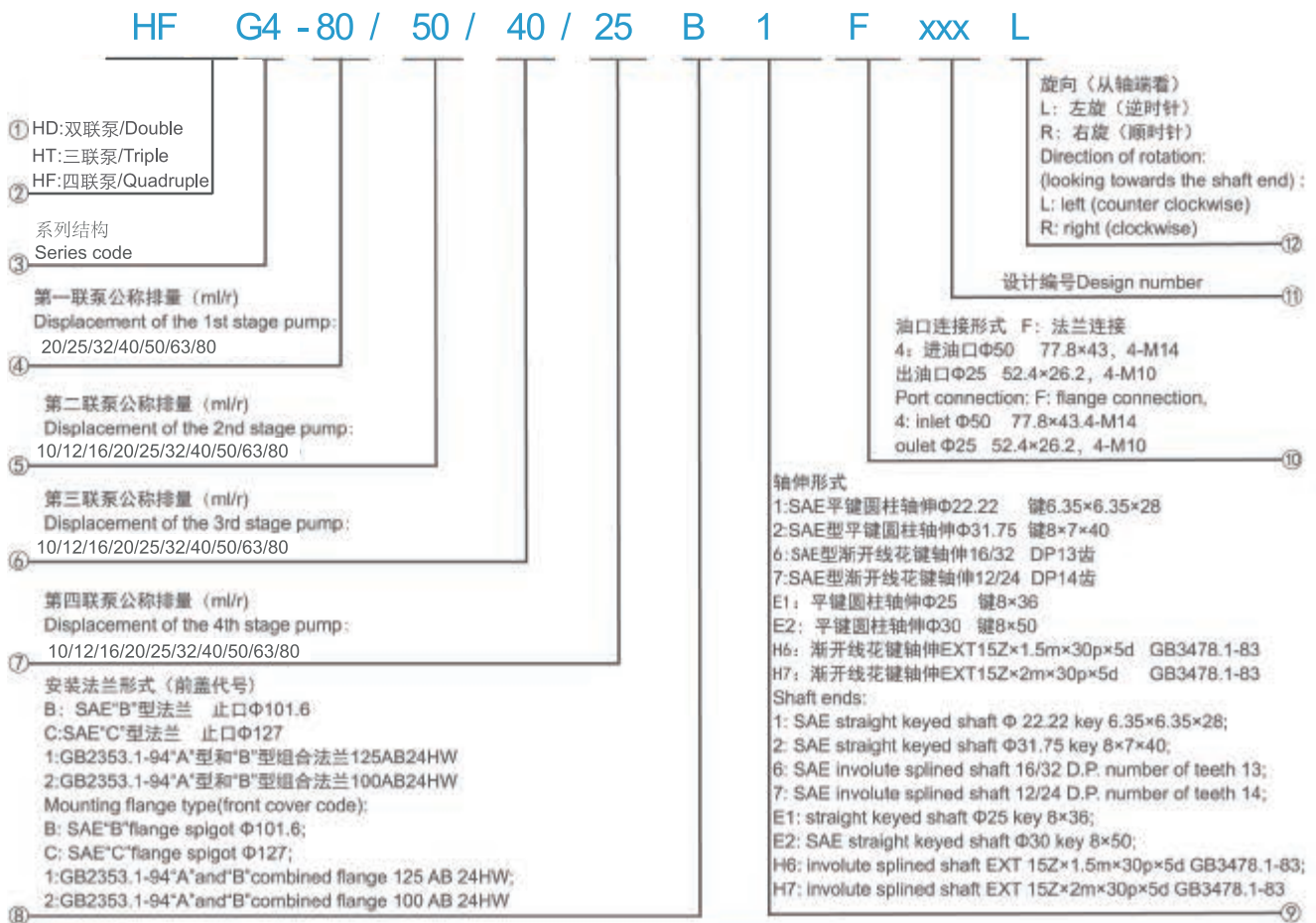

技术参数/Specifications

公称排量 Nominal displacement (ml/r)	理论排量 Theoretical displacement (ml/r)	额定压力 Rated pressure (Mpa)	公称转速 Nominal Speed (r/min)	最低转速 Min. Speed (r/min)	输入功率 (额定压力公称转速下) Power on rated work condition (KW)	第一联泵质量a1 Weight of the first stage pump a1 (Kg)	第二、三、四联泵 质量a2、a3、a4 Weight of the 2nd, 3rd, 4th stage pumps a2,a3,a4
20	21.0	25	3300	600	36.55	3.20	2.60
25	26.2	25	3300	600	45.60	3.50	2.90
32	32.8	25	3150	600	53.15	3.85	3.15
40	42.0	25	3000	600	64.81	4.30	3.56
50	52.5	23	2700	600	67.08	4.65	3.95
63	65.6	20	2500	500	67.49	5.15	4.40
80	78.7	18	2300	500	67.04	5.65	4.85

HDG4双联泵外形尺寸/HDG4 Series Type Dimensions

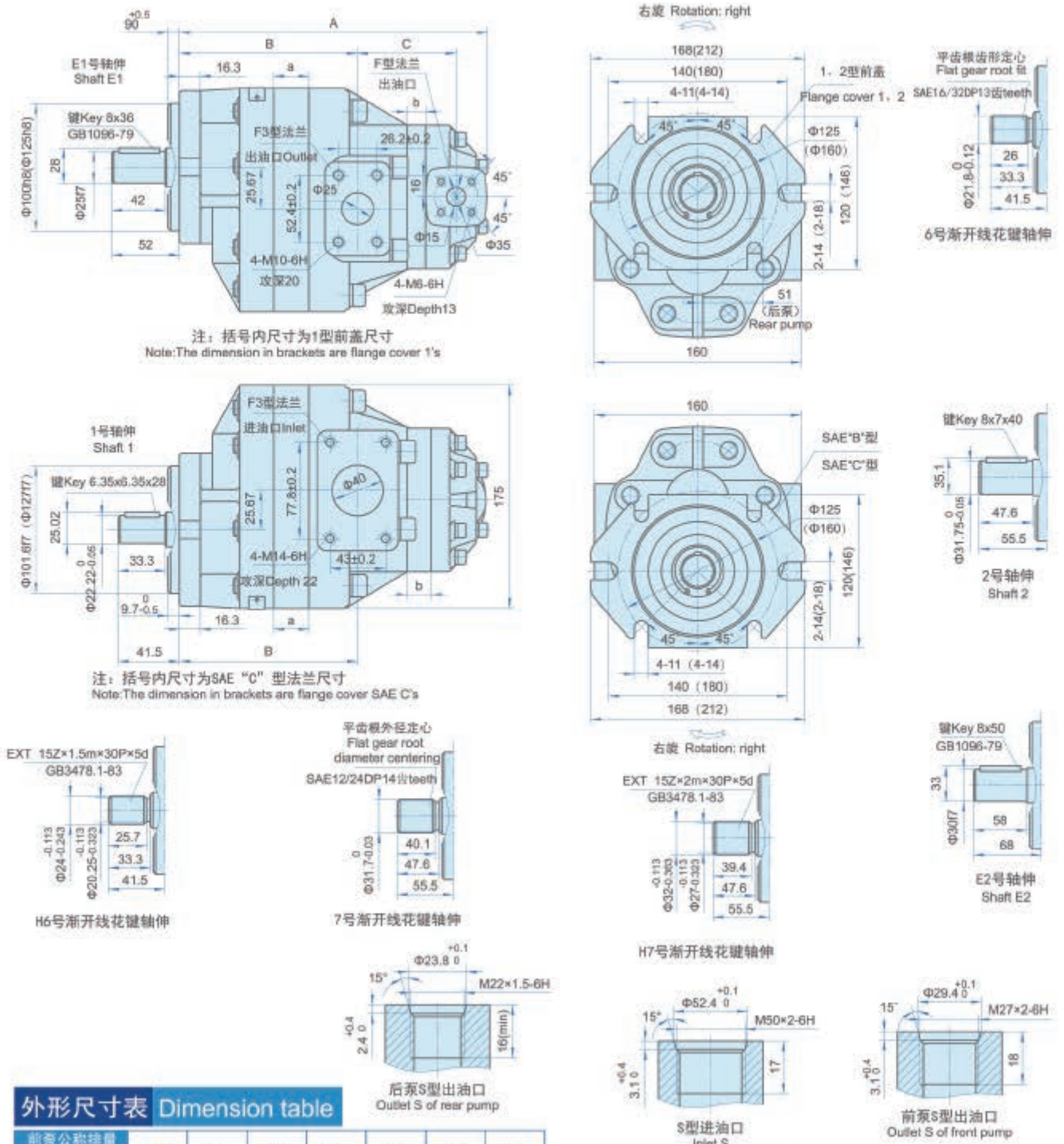

外形尺寸表 Dimension table

前泵公称排量 Nominal displacement of front pump	20	25	32	40	50	63	80
a	16	20	25	32	40	50	60
后泵公称排量 Nominal displacement of rear pump	5	6	8	10	12	16	20
b	8	10	12.5	15.5	19.5	24.5	30.5

A	192+a+b
B	108.3+a
C	59+b

HT(F)G4 多联泵外形尺寸/HT(F)G4 Series Type Dimensions

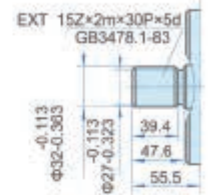
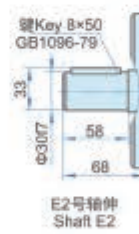
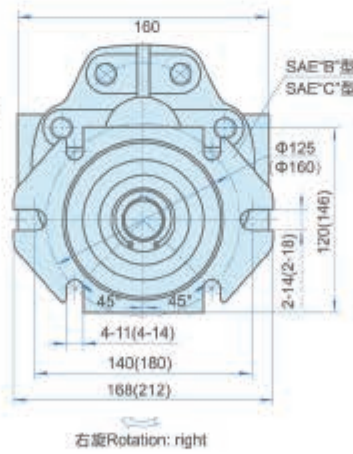
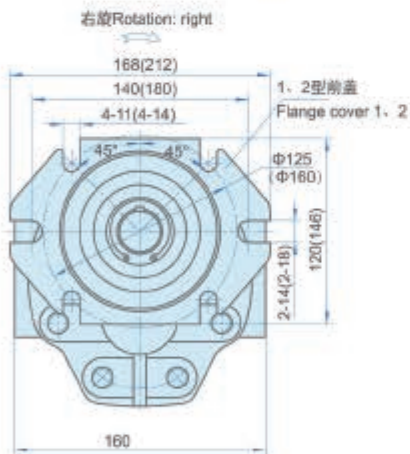
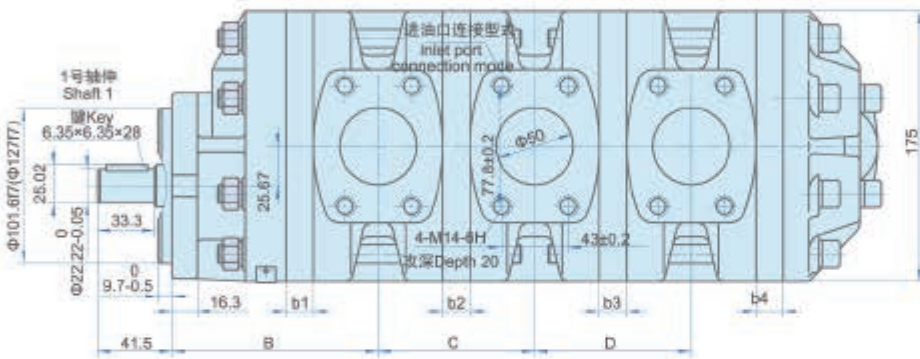
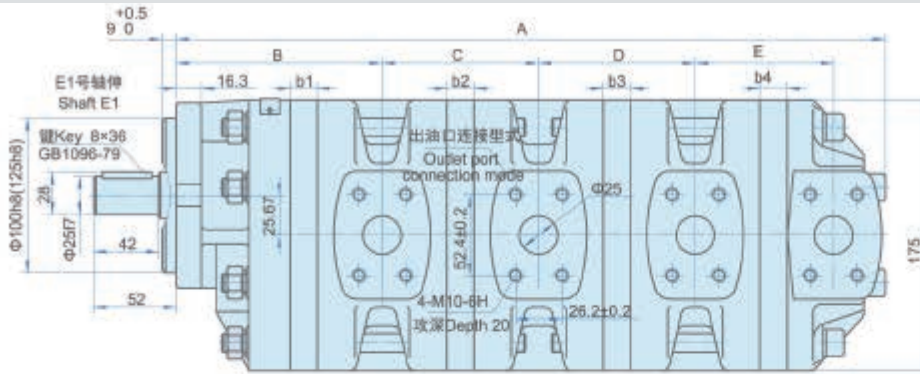

7号渐开线花键轴件

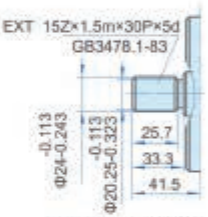

H6号渐开线花键轴件



8号渐开线花键轴件

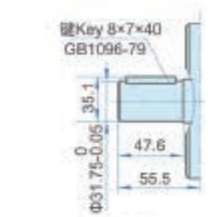

2号轴件 Shaft 2

外形尺寸表 Dimension table

公称排量 Nominal displacement	20	25	32	40	50	63	80
b1,b2,b3,b4	16	20	25	32	40	50	60
型式 Model	A		B	C	D	E	
双联 double pumps	220+b1+b2		113.5+b1	-	-	70+b2	
三联 triple pumps	300+b1+b2+b3			-	-	70+b3	
四联 quadruple pumps	380+b1+b2+b3+b4			80+b2	80+b3	70+b4	

负荷极限表 Allowable load of shaft

轴伸型式	轴伸负荷极限		连接轴负荷极限	
	双联泵 P1×V1+P2×V2		双联泵 P2×V2	
	三联泵 P1×V1+P2×V2+P3×V3		三联泵 P2×V2+P3×V3	
	四联泵 P1×V1+P2×V2+P3×V3+P4×V4		四联泵 P2×V2+P3×V3+P4×V4	
1, E1	<2150		<1150	
6, H6	<1550			
2, E2	<2300			
7, H7	<2300			

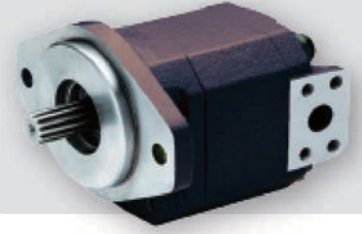

全铸铁泵HPQ3系列

HPQ3系列高压齿轮泵壳体全部采用高强度铸铁材质，设计用于高压，高工作强度的环境。HPQ3系列齿轮泵具有超长的使用寿命，并在恶劣的环境下提供可靠稳定的液压动力源。多种接口方式可定制。

型号 / Model number

HPQ3 A 30 F 1 02 R
 1 2 3 4 5 6 7

- | | | |
|---|--|--|
| <p>1. 系列型号/Series number
HPQ3铸铁泵/HPQ3 Cast iron series</p> <p>2. 安装形式/Mounting spigot diameter
— : 82.6 - Φ50.8
A : 106.4 - Φ82.55</p> <p>3. 规格/Size
10, 15, 20, 25, 30, 35, 40</p> | <p>4. 油口位置/Position of ports
F : 侧端/side ports
D : 后端/rear ports</p> <p>5. 油口形式/Port configuration
1 : F法兰/Flange typeF (见尺寸图see the drawing)
2 : G螺纹/G screw thread</p> | <p>6. 驱动轴类型/Shaft end
02 : 圆轴平键/Straight keyed shaft
13 : SAE 13齿花键/SAE Spline 13 teeth
XX : 定制接口/Option shaft end</p> <p>7. 旋向/Rotation viewing from shaft end
L : 逆时针/counterclockwise
R : 顺时针/clockwise</p> |
|---|--|--|

技术参数 / Specifications

规格/Size	排量 cm ³	流量* L/min	额定压力/Rated press		峰值压力/Max. press		转速/r/min		进口压力 Inlet pressure	外形尺寸/Dimension					
			MPa	bar	MPa	bar	MIN.	MAX.		进油口Inlet	出油口Outlet	A(mm)	B(mm)		
HPQ3-10	10.1	22	25	250	30	300	600	bar -0.20~2.0	G3/4"	G3/4"	122	96			
HPQ3-15	15.2	33									128	102			
HPQ3-20	20.3	45									135	108			
HPQ3-25	25.4	56							18	180	22	220	MPa -0.02~0.2	Port: Φ 32 4-M10 58.7x30.2	Port: Φ 19 4-M10 47.6x22.2
HPQ3-30	30.4	67	21	210	25	250	147	121							
HPQ3-35	35.5	78	154	127											
HPQ3-40	40.5	90	160	134											

*上表流量的标定状态为2000rpm转速下。

外形尺寸图/Dimensions

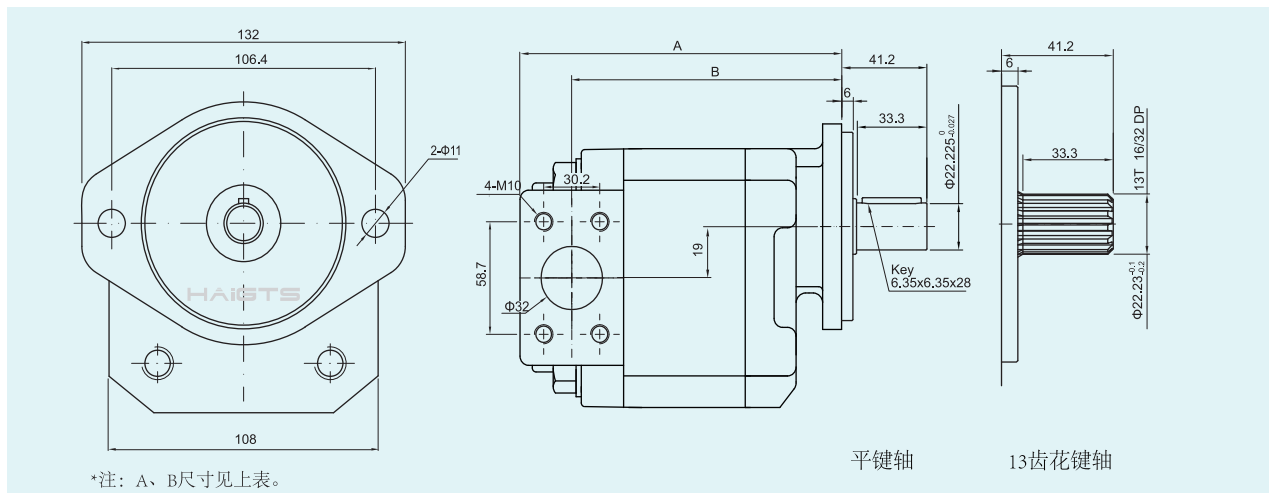



静音齿轮泵HPS3系列

型号/Model number

HPS3
A
36
F
1
02
R

1
2
3
4
5
6
7

- | | | |
|---|---|--|
| <p>1. 系列型号/Series number
HPS3系列/HPS3 series (铸铁/Cast Iron body)</p> <p>2. 安装形式/Mounting spigot diameter
-- : 82.6 - Φ50.8
A : 106.4 - Φ82.55</p> <p>3. 规格/Size
16, 18, 20, 23, 25, 27, 30, 32, 34, 36</p> | <p>4. 油口位置/Position of ports
F : 侧端/side ports
D : 后端/rear ports</p> <p>5. 油口形式/Port configuration
1 : 法兰/flange port (sides only)
2 : G螺纹/G screw thread</p> | <p>6. 驱动轴类型/Shaft end
02 : 圆轴平键/Straight keyed shaft
10 : SAE 10齿花键/SAE Spline 10 teeth
13 : SAE 13齿花键/SAE Spline 13 teeth</p> <p>7. 旋向/Rotation viewing from shaft end
L : 逆时针/counterclockwise
R : 顺时针/clockwise</p> |
|---|---|--|

技术参数/Specifications

规格/Size	排量/Displacement		额定压力/Rated pressure			峰值压力/Max. peak pressure			转速/r/min		进口压力 Inlet pressure	重量/Weight		
	cm ³	in ³	MPa	bar	psi	MPa	bar	psi	MIN.	MAX.		kg	lb	
HPS3-16	16.1	0.98	20	200	2900	24	240	3480	500	3600	bar -0.20~2.0	3.3	7.27	
HPS3-18	18.2	1.11										3.4	7.49	
HPS3-20	20.3	1.24										3.5	7.70	
HPS3-23	23.5	1.43										3.7	8.16	
HPS3-25	24.7	1.51										3.8	8.38	
HPS3-27	27.6	1.68										4.0	8.82	
HPS3-30	29.8	1.82							400	3000	MPa -0.02~0.2	4.1	9.04	
HPS3-32	32.5	1.98										4.2	9.26	
HPS3-34	34.1	2.08										psi -2.9 ~29	4.3	9.48
HPS3-36	36.4	2.22											4.5	9.92

分解图/Typical assembly

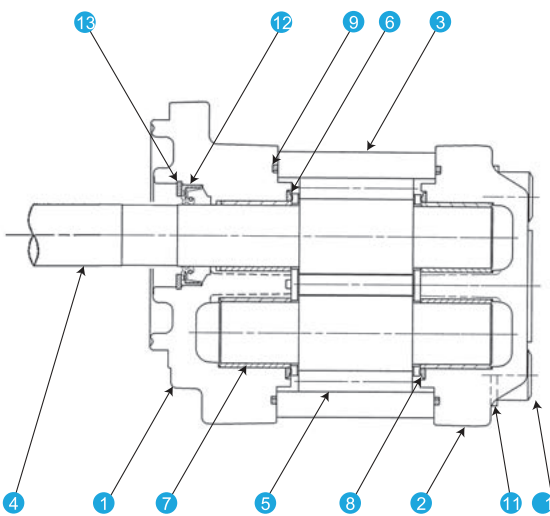

序号 ItemNo.	名称/Name	数量 QTY	材料/Material
1	前端盖/Front cover	1	铝合金/Aluminum alloy
2	后端盖/Rear cover	1	铝合金/Aluminum alloy
3	壳体/Body	1	铸铁/Cast iron
4	驱动齿/Drive gear	1	合金钢/Alloy steel
5	被动齿/Driven gear	1	合金钢/Alloy steel
6	侧板/Side plate	2	特殊合金钢/Special alloy steel
7	轴套/Bush	2	特殊合金钢/Special alloy steel
8	密封/Gasket	2	丁腈橡胶/Nitrile rubber
9	密封/Gasket	2	丁腈橡胶/Nitrile rubber
10	螺栓/Bolt	4	合金钢/Alloy steel
11	垫片/Washer	4	碳钢/Carbon steel
12	油封/Oil seal	1	丁腈橡胶/Nitrile rubber
13	卡簧/Retainer ring	1	碳素工具钢/Carbon tool steel

HPS3 系列外形尺寸/HPS3 Series Dimensions

外形尺寸/Dimensions

尺寸单位/dimensions : mm

HPS3**F1 **L (侧端/Side ports)

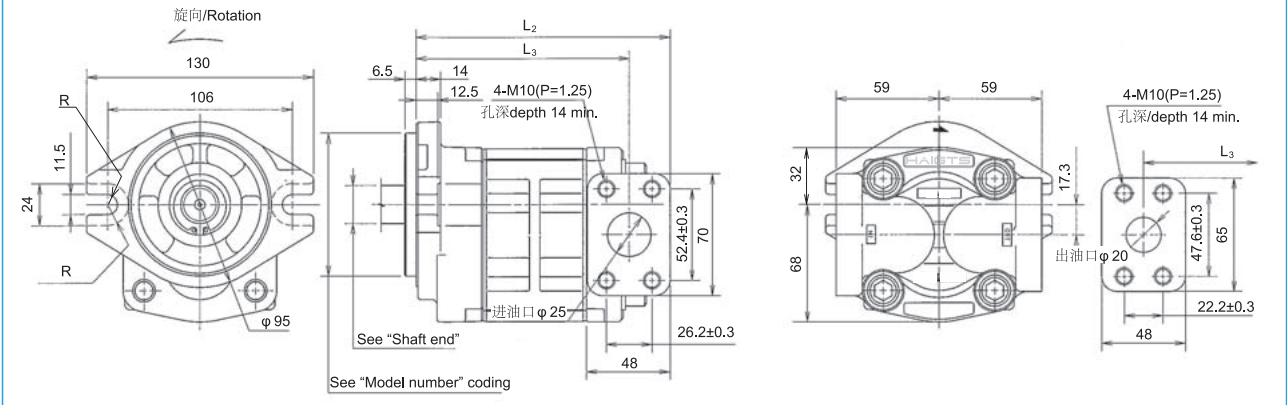

HPS3**D2**L (后端/Rear ports)

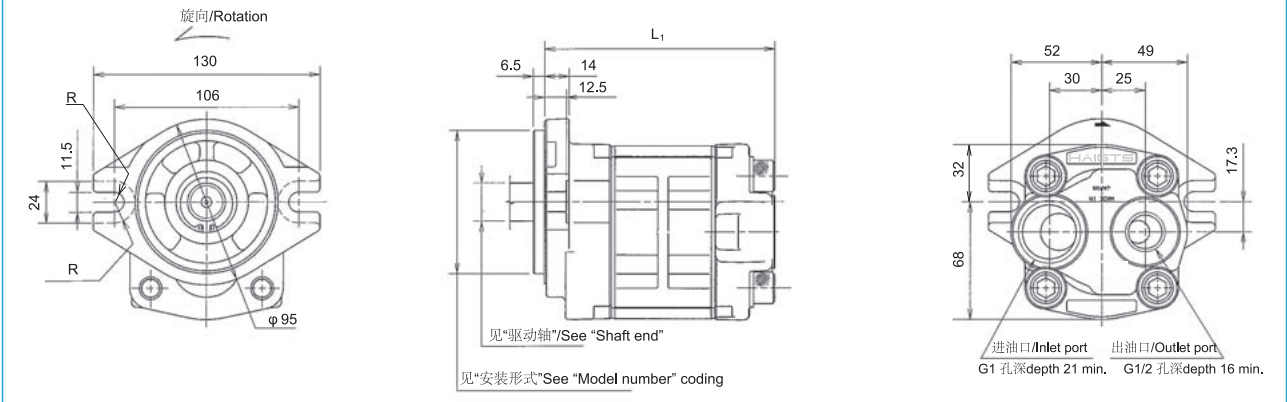

规格/Size	L_1	L_2	L_3
16	108.0	121.5	98.0
18	110.5	124.0	100.5
20	113.0	126.5	103.0
23	117.0	130.5	107.0
25	118.5	132.0	108.5
27	122.0	135.5	112.0
30	124.5	138.0	114.5
32	128.5	142.0	118.5
34	129.5	143.0	119.5
36	132.5	146.0	122.5

驱动轴/Shaft end

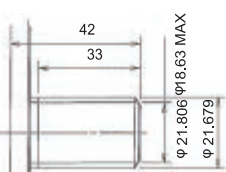
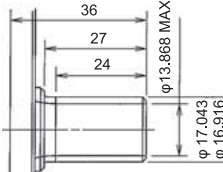
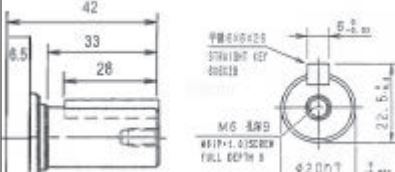
SAE13齿花键轴/SAE Spline13 teeth	SAE10齿花键轴/SAE Spline10 teeth	Straight Keyed Shaft end
 <p>No. of tooth : 13 D.P. : 16/32 Pressure angle : 30° Over pin dia. : 24.891 24.819 Pin dia. : $\phi 3.048$</p>	 <p>No. of tooth : 10 D.P. : 16/32 Pressure angle : 30° Over pin dia. : 20.263 20.193 Pin dia. : $\phi 3.048$</p>	 <p>STRAIGHT KEY SHAFT END M6 六角 M10x1.0 SCREW FULL DEPTH 8 $\phi 20.07$</p>

HPS3 系列性能曲线/HPS3 Series Performance curves

HPS3-16cc

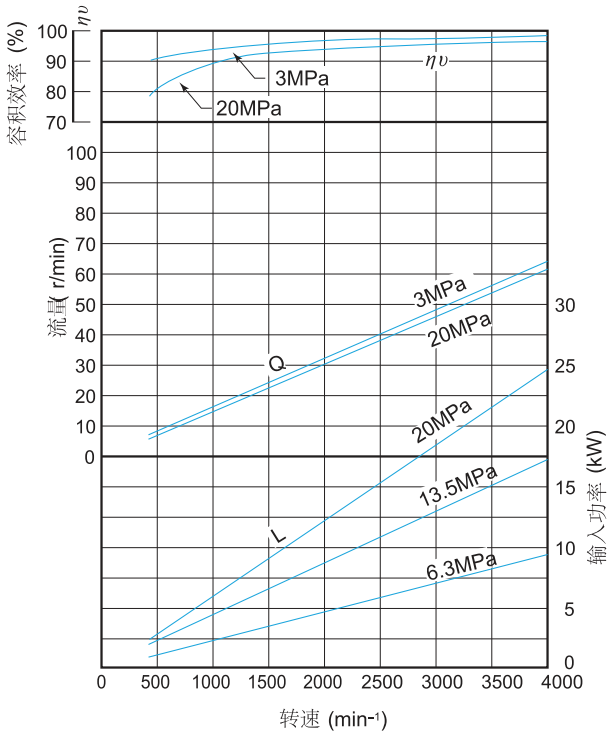

HPS3-18cc

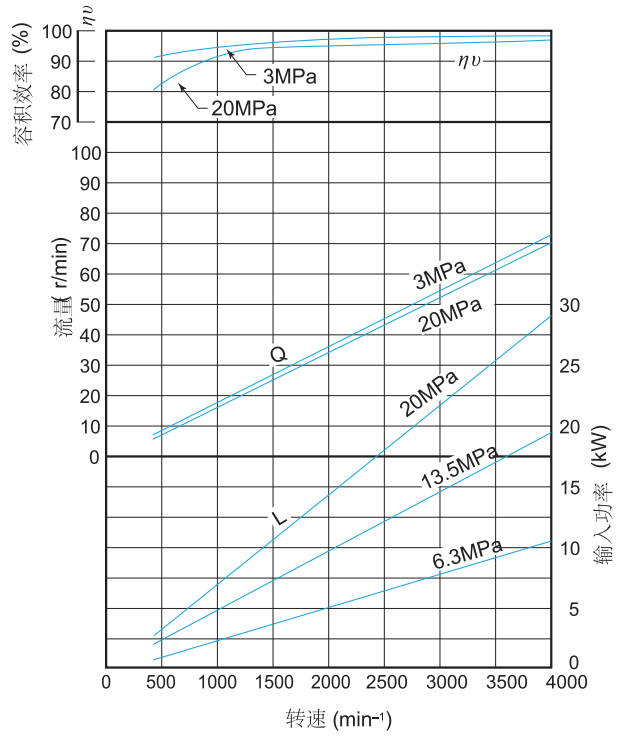

HPS3-20cc

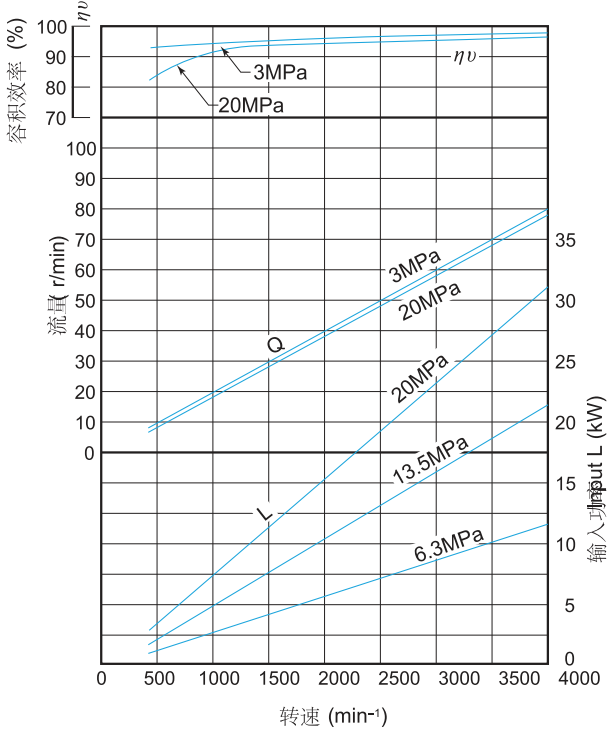

HPS3-23cc

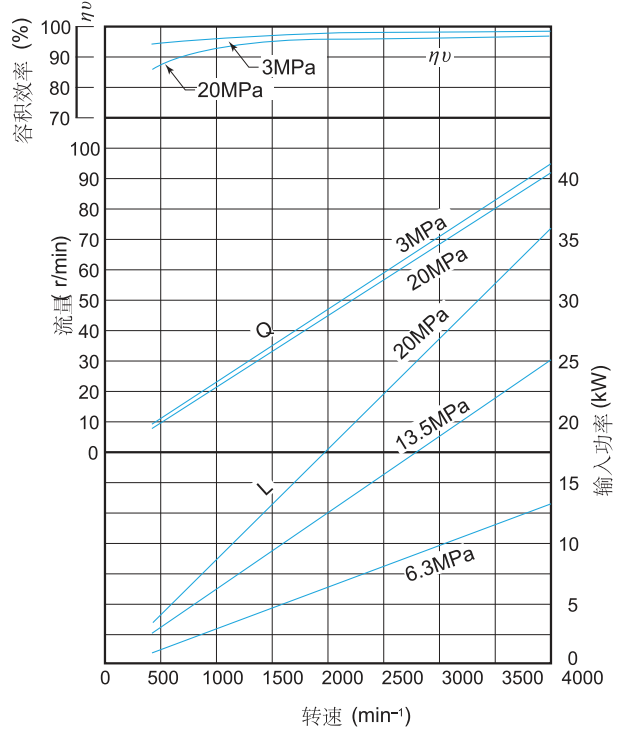

OIL: ISO VG32 Hydraulic Fluid at 40°C

HPS3 系列性能曲线/HPS3 Series Performance curves

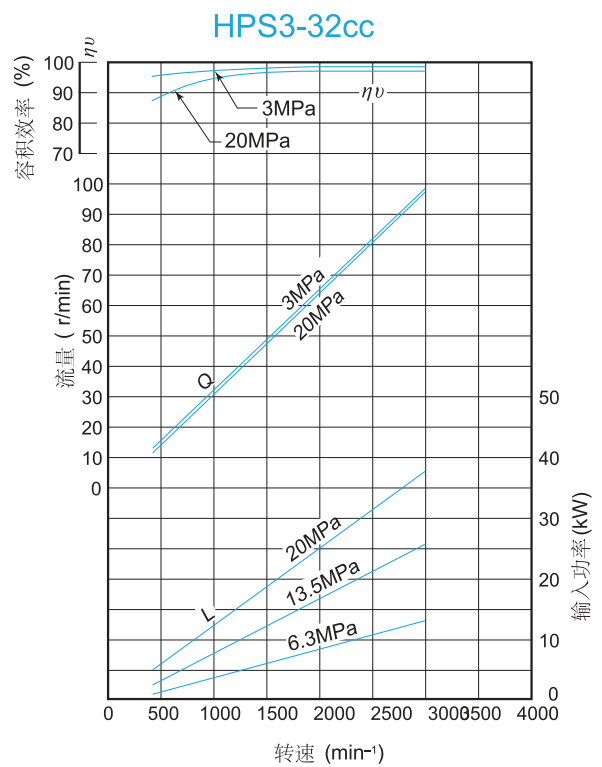
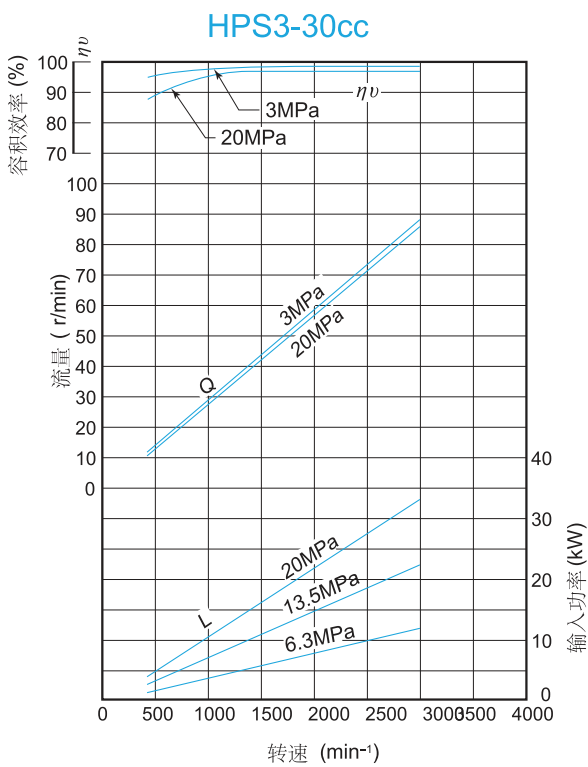
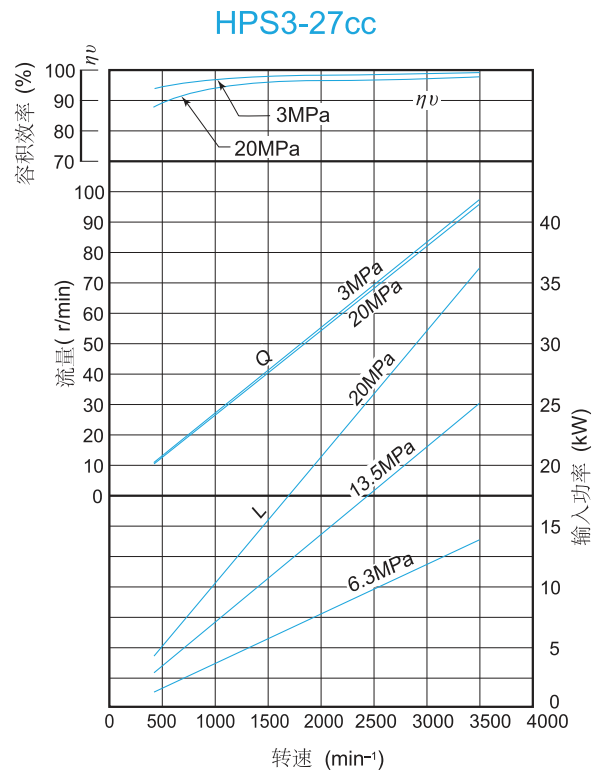
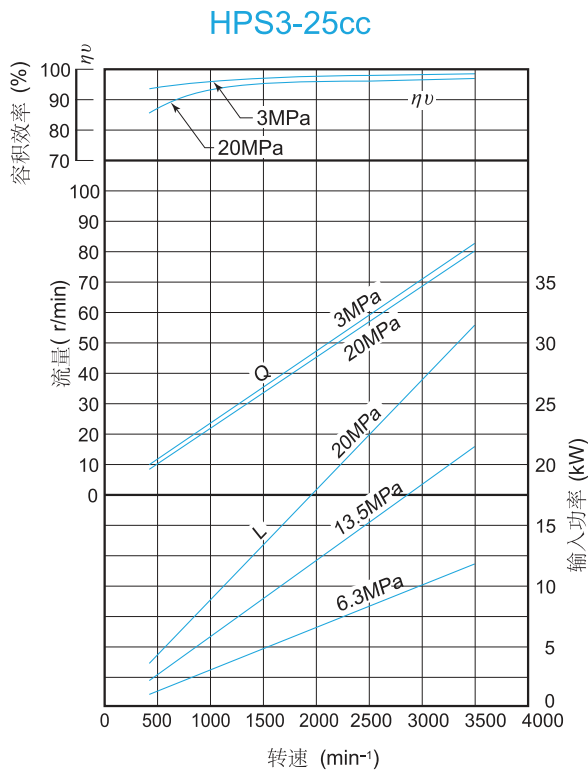

OIL: ISO VG32 Hydraulic Fluid at 40°C

HPS3 系列性能曲线/HPS3 Series Performance curves

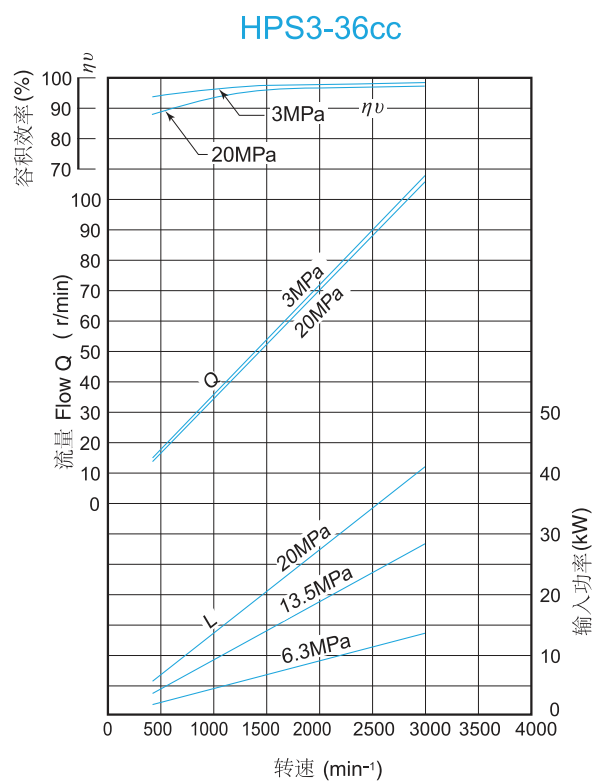
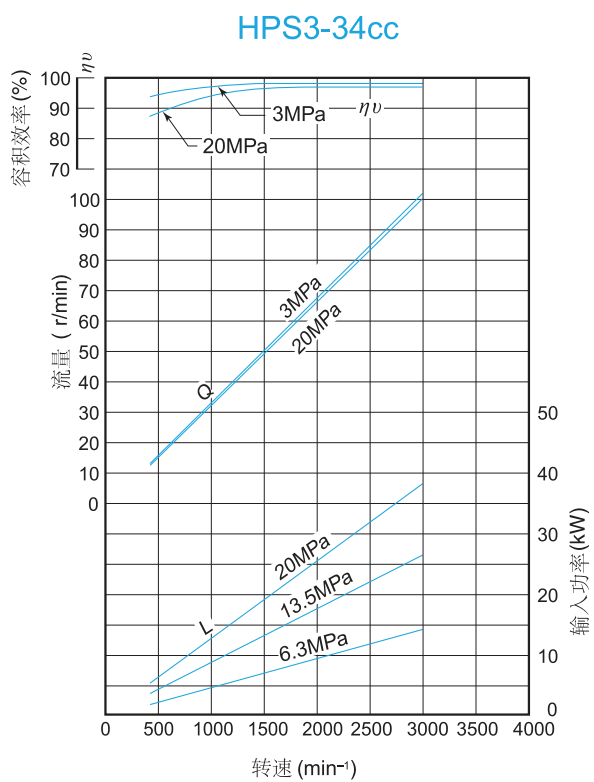

齿轮马达HMM4系列

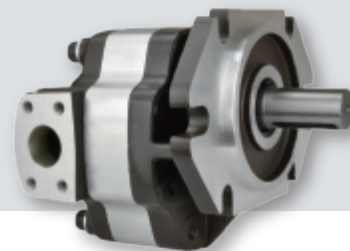

HMM4系列是基于美国VICKERS技术研发的高压力宽流量齿轮马达，设计用于高压力，高工作强度的环境。广泛用于移动机械，工程机械，起重机等液压系统。

HMM4系列可提供多种接口方式。

型号/Model number

HMM4 B 63 F 1 01 R

1 2 3 4 5 6 7

- | | | |
|---|--|---|
| <p>1. 系列型号/Series number
HMM4单马达/Single HMM4</p> <p>2. 安装形式/Mounting spigot dia.
A: 106.4 - Φ82.55
B: 146 - Φ101.6</p> <p>3. 规格/Size
20、26、32、40、50、63、80</p> | <p>4. 油口位置/Position of ports
F: 侧端/side ports
D: 后端/rear ports</p> <p>5. 油口形式/Port configuration
1: F法兰/Flange typeF (见尺寸图see the drawing)</p> | <p>6. 驱动轴类型/Shaft end
01: Φ30圆轴平键/Straight keyed shaft
02: Φ22圆轴平键/Straight keyed shaft
15: SAE 15齿花键/SAE Spline 15 teeth</p> <p>7. 旋向/Rotation viewing from shaft end
L: 逆时针/ counterclockwise
R: 顺时针/ clockwise</p> |
|---|--|---|

技术参数/Specifications

规格/Size	排量	理论扭矩	额定压力	转速 r/min		外形尺寸 / Dimension			重量/Weight
	cm ³	N.M	Mpa	MAX.	MIN.	进油口	A(mm)	B(mm)	Kg
HMM4-20	21	66	20	3000	900	SAE 法兰 1-1/4"	156	119	8.3
HMM4-25	26	83					160	123	8.6
HMM4-32	32	104					165	128	9.0
HMM4-40	42	133					172	135	9.4
HMM4-50	52	167					180	143	9.8
HMM4-63	65	208	18	2500	700	(泄油口 M14x1.5)	190	153	10.2
HMM4-80	79	225					200	163	10.8

外形尺寸图/Dimensions

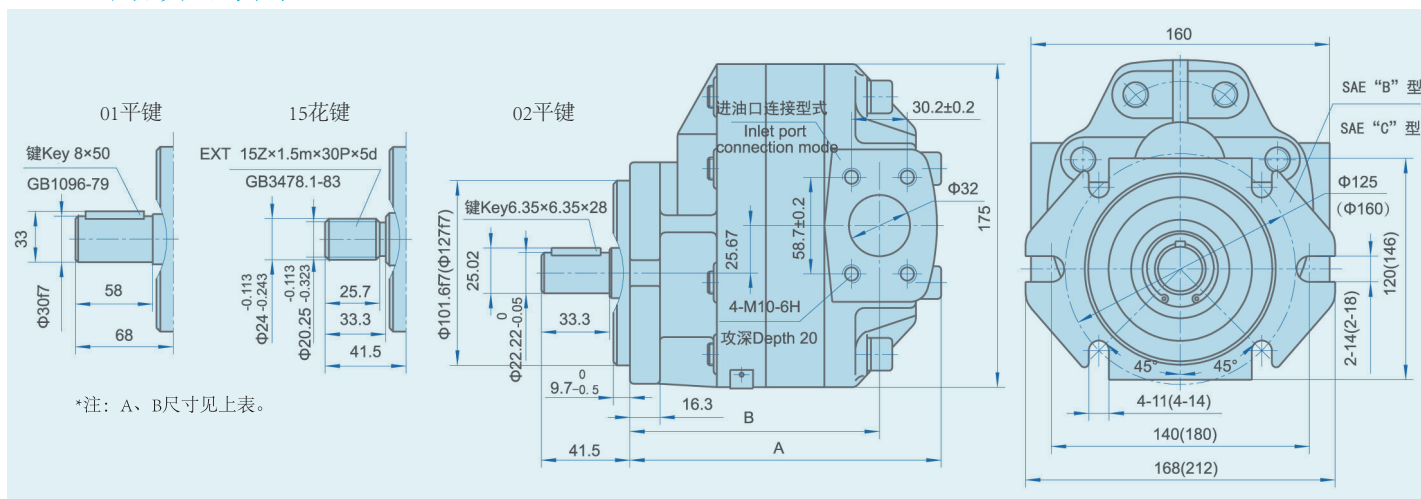

其他产品系列

内啮合齿轮泵



螺杆泵



冷却器



软管总成和接头

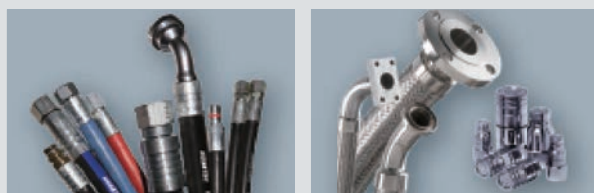

液压系统



定制液压缸



公司为众多国际知名厂家长期代工精密金属部件加工和组装业务。





PROFESSIONAL HYDRAULIC COMPANY

重庆派若特科技发展有限公司

18580892689

15023307788@163.com

